

LEITH JUNCTION

New lightweight technical galleries would be suspended below the existing barrel vault ceiling, and the intention is that all interventions would respect and preserve the architectural character of the space, working with the existing balcony structure and structural bays of the Main Hall.

By building up the proscenium arch we can create an independent studio space on the existing stage. The refurbishment of the 'Artistes Block' can provide useful Studio and meeting room accommodation, potentially linking with the Leith School of Art via a glazed 'courtyard' space.

The Thomas Morton Hall would require redecoration and some improvement in its technical performance, but essentially this space functions well. Similarly, by the removal of the crude partitions at the upper level and an introduction of a passenger lift, the foyer sequence can be restored to the original intent and once more provide access to both the Thomas Morton Hall and the main theatre space.

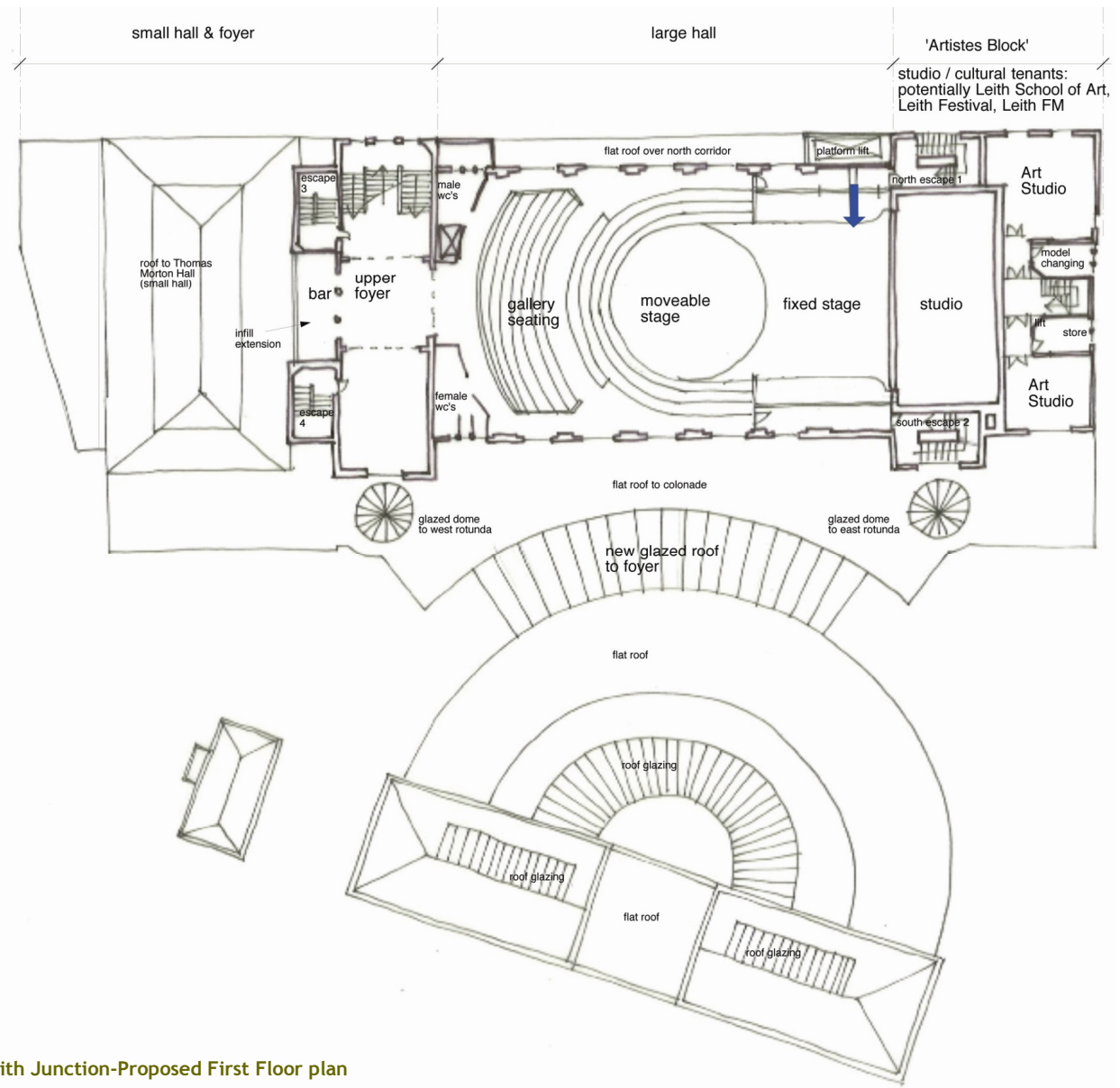

Leith Junction-Proposed First Floor plan